



THERMOWELL

MODEL FTW01 &
FTW02

FTW01

Thermowells
Bar Stock (Screwed)

- Design as per PTC 19.3
- These Thermowells are manufactured from solid bar stock and installed into the process with the help of threaded process connection.
- This design is suitable for all type of RTD's, Thermocouples, mechanical as well as digital thermometers
- Available in various shapes like Straight, Straight with reduced tip, partial taper & full taper

■ THERMOWELL DRAWINGS

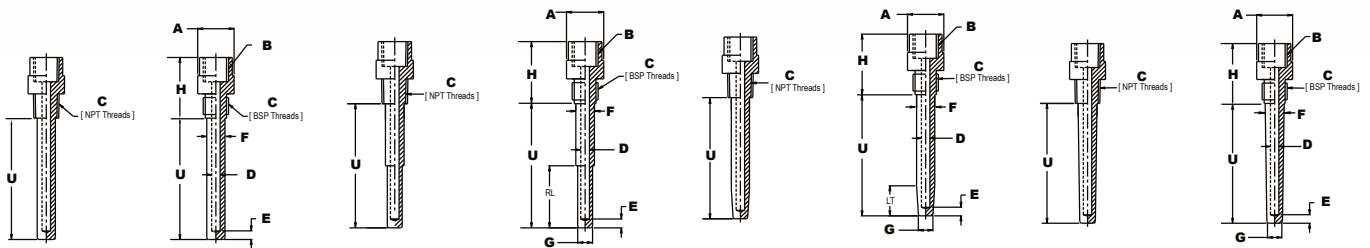

S - Straight

R - Straight Reduced Tip

P - Partial Taper

F - Full Taper

- A** - Finished Head Size
- B** - Instrument Connection
- C** - Process Connection
- D** - Bore Diameter

- E** - Tip Thickness
- F** - Major Diameter
- G** - Minor Diameter
- H** - Extension Length

- U** - Insertion Length
- RL** - Reduced Tip Length
- LT** - Taper Length

Thermowell Installation

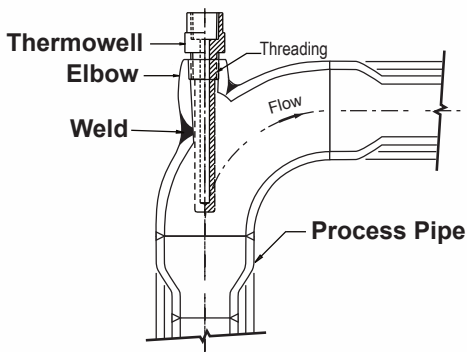



FTW01

Thermowells
Bar Stock (Screwed)

How To Order				Example
Basic Model				FTW01
Type				
S - Straight	R - Straight Reduced Tip	P - Partial Taper	F - Full Taper	X
Material				
LQ Carbon Steel	LO AISI 316Ti SS	LT Monel	LV Titanium	XX
LP AISI 304 SS	ER AISI 304L SS	LU Inconel 600	LW Tantalum	
LM AISI 316 SS	LR Hastelloy B	ES Inconel 625	LX Nickel	
LN AISI 316L SS	LS Hastelloy C	ET Incolloy 800	LY HRS 446	
EN AISI 321 SS		EU Incolloy 825	LZ Alloy 20	
EO AISI 310 SS			EV Kanthal	
Other Materials are available on request.				
Instrument Connection				
3BF 3/8" BSP(F)	4BF 1/2" BSP(F)	5BF 3/4" BSP(F)		XXX
31F 3/8" NPT(F)	41F 1/2" NPT(F)	51F 3/4" NPT(F)		
Other Materials are available on request.				
Process Connection "C"				
4BM 1/2" BSP (M)	5BM 3/4" BSP (M)	6BM 1" BSP (M)		XXX
4NM 1/2" NPT (M)	5NM 3/4" NPT (M)	6NM 1" NPT (M)		
Other Materials are available on request.				
Bore Diameter "D"				
B 7mm	D 9mm	F 11mm	G 13mm	X



FTW02

Thermowells
Built-in From Pipe & Bar Stock (Flanged)

Special Features

- These thermowells are manufactured from solid bar stock pieces and welded in between as per the longer length requirement and installed into the process by using a bolted flanged connection
- This design is suitable for all type of rtd's, thermocouples, mechanical as well as digital thermometers which are having very longer lengths
- Full penetration welded at flange area

Applications

- Chemical plants
- Petrochemical plants
- Engineering plants
- On shore
- Off shore & other similar process industries

THERMOWELL DRAWINGS

A - Finished Head Size
B - Instrument Connection
C - Flange
D - Bore Diameter of Tail Bar Stock

E - Tip Thickness
F - Major Diameter
G - Minor Diameter
H - Extension Length

U - Insertion Length
Lt - Taper Length
I - Length of Pipe

Thermowell Drawings

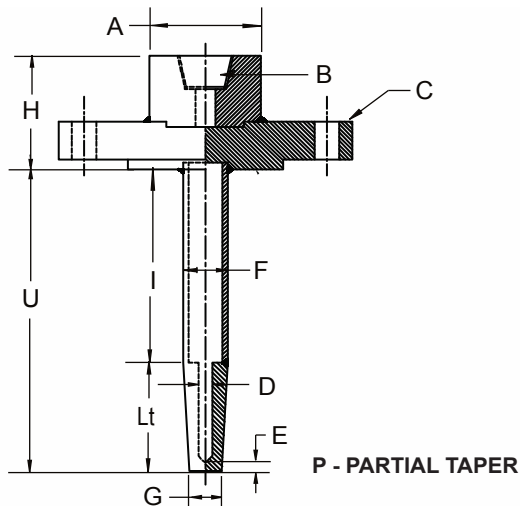

Thermowell Installation

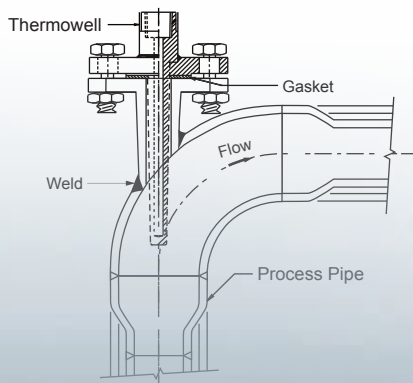



FTW02

Thermowells
Built-in From Pipe & Bar Stock (Flanged)

How To Order				Example
Basic Model				FTW02
Flange & Stub Material				
LM AISI 316SS	EN AISI 321 SS	LS Hastelloy C		XX
LN AISI 316L SS	LQ Carbon Steel	LV Titanium		
LP AISI 304 SS	LT Monel	LU Inconel 600		
Other Materials are available on request.				
Instrument Connection				
4BF ½" BSP (F)	5NF ¾" NPT (F)	6NF 1" NPT (F)		XXX
4NF ½" NPT (F)	5BF ¾" BSP (F)	6BF 1" BSP (F)		
Other Materials are available on request.				
Flange Type				
1 Blind Flange	2 SORF Flange			X
Flange "C" (Size & Rating)				XXX
Flange Facing Type				
R Raised Face	F Flat Face	J Ring type joint		X
Flange Finish				
1 - 125 AARH (Standard)				X
Other Materials are available on request.				
Bore Diameter				X
B 7mm	D 9mm	F 11mm	G 13MM	
Shank Material				
LM AISI 316 SS	EN AISI 321 SS	LS Hastelloy C		
LN AISI 316L SS	EO AISI 310 SS	ES Inconel 625		
LO AISI 316Ti SS	LT Monel	LU Inconel 600		
Other Materials are available on request.				
Insertion Length "U"				
Please specify in mm				
Note : Specifications and dimensions given in this product catalogue represents the state of engineering at the time of printing. Modifications may take place and materials specified may be replaced by others without prior notice				

Why Choose Us?

With our manufacturing presence in SAIF Zone, Sharjah, UAE, we are able to offer



Variety of Graded Raw Material, sourced from Europe, Japan & North America



Intrusive Stage-wise Inspections as per Requirements



Compliance to NDE Requirements as per Project Specifications



10+ years of Experience in Operation



Instant Availability Of Spare Parts



Prompt Site Service Support within the UAE And GCC



200+ Clients Worldwide



Team of 30+ Technical Professionals

Our Clients



Sonangol Distribuidora



SOCAR



Occidental of Oman Inc.
أوكسيدنتال عمان انكروپريتد





©2021 Globe United FZE, All rights reserved.

All rights and credit go directly to its rightful owners. No copyright infringement intended.

📍 T5-41, Sharjah Airport International Free Zone, Sharjah, United Arab Emirates

☎ T: +971 65585309 | M: +971 55 9998947

📺 🐦 📌 : Globe United FZE



globeunitedae.com
or scan



Globe United FZE
or scan

